

# 过渡接头 ADAPTER

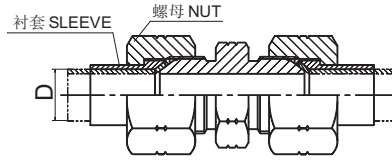
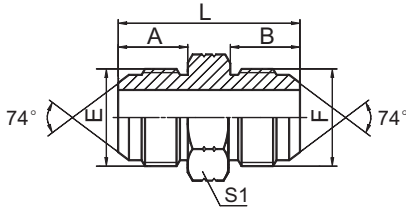

美制 JIC 外螺纹 74° 外锥  
JIC MALE 74° CONE

## 1J

代号 PART NO.	螺纹 THREAD		尺寸 DIMENSIONS					
	E	F		A	B	L	S1	
1J-02	5/16"X24	5/16"X24		11.4	11.4	29	12	
1J-02-03	5/16"X24	3/8"X24		11.4	12.2	29.5	12	
1J-03	3/8"X24	3/8"X24		12.2	12.2	30.5	12	
1J-04	7/16"X20	7/16"X20		14	14	34	12	
1J-04-05	7/16"X20	1/2"X20		14	14	34	14	
1J-04-06	7/16"X20	9/16"X18		14	14.1	34.1	17	
1J-04-08	7/16"X20	3/4"X16		14	16.7	38.5	22	
1J-05	1/2"X20	1/2"X20		14	14	34	14	
1J-05-06	1/2"X20	9/16"X18		14	14.1	34	17	
1J-05-08	1/2"X20	3/4"X16		14	16.7	38.5	22	
1J-05-10	1/2"X20	7/8"X14		14	19.3	41	24	
1J-06	9/16"X18	9/16"X18		14.4	14.1	34.2	17	
1J-06-08	9/16"X18	3/4"X16		14.1	16.7	38.5	22	
1J-06-10	9/16"X18	7/8"X14		14.1	19.3	41.5	24	
1J-06-12	9/16"X18	1.1/16"X12		14.1	21.9	46	30	
1J-08	3/4"X16	3/4"X16		16.7	16.7	42	22	
1J-08-10	3/4"X16	7/8"X14		16.7	19.3	44	24	
1J-08-12	3/4"X16	1.1/16"X12		16.7	21.9	48.5	30	
1J-08-16	3/4"X16	1.5/16"X12		16.7	23.1	51	36	
1J-10	7/8"X14	7/8"X14		19.3	19.3	46.5	24	
1J-10-12	7/8"X14	1.1/16"X12		19.3	21.9	51	30	
1J-10-16	7/8"X14	1.5/16"X12		19.3	23.1	53.5	36	
1J-12	1.1/16"X12	1.1/16"X12		21.9	21.9	54	30	
1J-12-14	1.1/16"X12	1.3/16"X12		21.9	22.6	55.5	32	
1J-12-16	1.1/16"X12	1.5/16"X12		21.9	23.1	56	36	
1J-14	1.3/16"X12	1.3/16"X12		22.6	22.6	56	32	
1J-14-16	1.3/16"X12	1.5/16"X12		22.6	23.1	56.5	36	
1J-16	1.5/16"X12	1.5/16"X12		23.1	23.1	57	36	
1J-16-20	1.5/16"X12	1.5/8"X12		23.1	24.3	60.5	46	
1J-16-24	1.5/16"X12	1.7/8"X12		23.1	27.5	65.5	50	
1J-20	1.5/8"X12	1.5/8"X12		24.3	24.3	62	46	
1J-20-24	1.5/8"X12	1.7/8"X12		24.3	27.5	67	50	
1J-20-32	1.5/8"X12	2.1/2"X12		24.3	33.9	75	65	
1J-24	1.7/8"X12	1.7/8"X12		27.5	27.5	70	50	
1J-24-32	1.7/8"X12	2.1/2"X12		27.5	33.9	78.5	65	
1J-32	2.1/2"X12	2.1/2"X12		33.9	33.9	85	65	

注：螺母及衬套需另行订货。管子直径 D 为公制时，配用螺母及衬套分别选用 NB200、NB500。管子直径为英制时，配用螺母及衬套分别选用 NB200、NB300。Note: Nut and sleeve should be ordered separately. The nut NB200 and sleeve NB500 is suitable for metric tube, the nut NB200 and sleeve NB300 is suitable for inch tube.