

过渡接头 ADAPTER

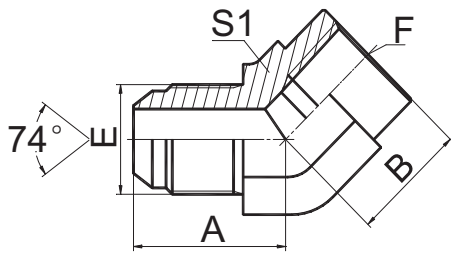

5JN4

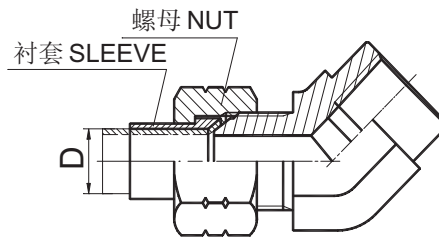

5JN4-RN

45° JIC 外螺纹 74° 外锥 / 布锥管内螺纹
45° JIC MALE 74° CONE/NPT FEMALE

代号 PART NO.	螺纹 THREAD		尺寸 DIMENSIONS					
	E	F	A	B	S1			
5JN4-04	7/16"X20	Z1/4"X18	23	20	19			
5JN4-06-04	9/16"X18	Z1/4"X18	24	20	19			
5JN4-06	9/16"X18	Z3/8"X18	26	19	24			
5JN4-08-06	3/4"X16	Z3/8"X18	29.5	19	24			
5JN4-08	3/4"X16	Z1/2"X14	29.5	28	30			
5JN4-10-08	7/8"X14	Z1/2"X14	33	28	30			
5JN4-12	1.1/16"X12	Z3/4"X14	37.5	30	33			
5JN4-14-12	1.3/16"X12	Z3/4"X14	38	30	33			
5JN4-16	1.5/16"X12	Z1"X11.5	42	37.5	41			
5JN4-20	1.5/8"X12	Z1.1/4"X11.5	46	30	48			
5JN4-24	1.7/8"X12	Z1.1/2"X11.5	58	36	63			

注：螺母及衬套需另行订货。管子直径D为公制时，配用螺母及衬套分别选用NB200、NB500。管子直径为英制时，配用螺母及衬套分别选用NB200、NB300。 Nut and sleeve should be ordered separately. The nut NB200 and sleeve NB500 is suitable for metric tube, the nut NB200 and sleeve NB300 is suitable for inch tube.