

# DIN 卡套式管接头

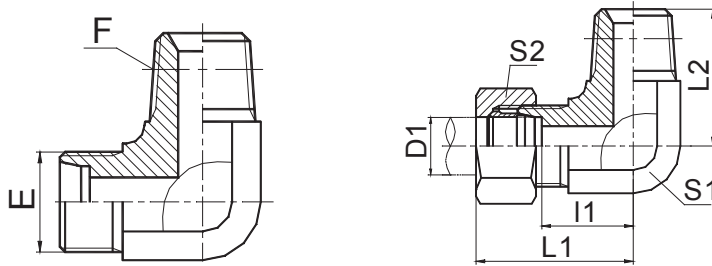

90° 弯英锥管外螺纹  
90° ELBOW BSPT MALE

**1CT9-SP**  
**1DT9-SP**

**1CT9-SP/RN**  
**1DT9-SP/RN**

| 代号<br>PART NO. | 螺纹 THREAD |            | 管子外径 TUBE O.D. |    | 尺寸 DIMENSIONS |      |      |    |    | 压力等级<br>MPa      |
|----------------|-----------|------------|----------------|----|---------------|------|------|----|----|------------------|
|                | E         | F          | D1             |    | l1            | L1   | L2   | S1 | S2 |                  |
| 1CT9-12-02SP   | M12X1.5   | R1/8"X28   | 6              |    | 13            | 28   | 21   | 11 | 14 | 31.5<br>轻系列<br>L |
| 1CT9-12-04SP   | M12X1.5   | R1/4"X19   | 6              |    | 15.5          | 30.5 | 25.5 | 14 | 14 |                  |
| 1CT9-14-02SP   | M14X1.5   | R1/8"X28   | 8              |    | 15.5          | 30.5 | 23.5 | 14 | 17 |                  |
| 1CT9-14-04SP   | M14X1.5   | R1/4"X19   | 8              | 8  | 15.5          | 30.5 | 25.5 | 14 | 17 |                  |
| 1CT9-16-04SP   | M16X1.5   | R1/4"X19   | 10             |    | 17.5          | 32.5 | 26.5 | 16 | 19 |                  |
| 1CT9-16-06SP   | M16X1.5   | R3/8"X19   | 10             | 10 | 17.5          | 32.5 | 28.5 | 16 | 19 |                  |
| 1CT9-16-08SP   | M16X1.5   | R1/2"X14   | 10             |    | 21            | 36   | 36   | 22 | 19 |                  |
| 1CT9-18-04SP   | M18X1.5   | R1/4"X19   | 12             | 12 | 21            | 34   | 28   | 19 | 22 |                  |
| 1CT9-18-06SP   | M18X1.5   | R3/8"X19   | 12             |    | 19            | 34   | 30.5 | 19 | 22 |                  |
| 1CT9-18-08SP   | M18X1.5   | R1/2"X14   | 12             |    | 21            | 36   | 36   | 22 | 22 |                  |
| 1CT9-22-06SP   | M22X1.5   | R3/8"X19   | 15             | 15 | 22            | 37   | 32.5 | 22 | 27 |                  |
| 1CT9-22-08SP   | M22X1.5   | R1/2"X14   | 15             | 15 | 22            | 37   | 36   | 22 | 27 |                  |
| 1CT9-22-12SP   | M22X1.5   | R3/4"X14   | 15             |    | 25.5          | 40.5 | 43.5 | 27 | 27 |                  |
| 1CT9-26-08SP   | M26X1.5   | R1/2"X14   | 18             | 18 | 25.5          | 42   | 39.5 | 27 | 32 |                  |
| 1CT9-26-12SP   | M26X1.5   | R3/4"X14   | 18             | 18 | 25.5          | 42   | 43.5 | 27 | 32 |                  |
| 1CT9-30-12SP   | M30X2     | R3/4"X14   | 22             | 22 | 29.5          | 45.8 | 45.3 | 30 | 36 |                  |
| 1CT9-30-16SP   | M30X2     | R1"X11     | 22             |    | 31.5          | 48   | 50   | 33 | 36 |                  |
| 1CT9-36-16SP   | M36X2     | R1"X11     | 28             | 28 | 33.3          | 49.8 | 52   | 36 | 41 |                  |
| 1CT9-36-20SP   | M36X2     | R1.1/4"X11 | 28             |    | 36.2          | 52.7 | 57   | 41 | 41 |                  |
| 1CT9-45-20SP   | M45X2     | R1.1/4"X11 | 35             | 35 | 39.2          | 60.7 | 61   | 48 | 50 |                  |
| 1CT9-52-24SP   | M52X2     | R1.1/2"X11 | 42             | 42 | 44.8          | 67.8 | 68   | 55 | 60 |                  |
| 1DT9-14-04SP   | M14X1.5   | R1/4"X19   | 6              | 6  | 17.5          | 32.5 | 25.5 | 14 | 17 |                  |
| 1DT9-16-04SP   | M16X1.5   | R1/4"X19   | 8              |    | 18.7          | 33.7 | 26.5 | 16 | 19 |                  |
| 1DT9-18-06SP   | M18X1.5   | R3/8"X19   | 10             |    | 19.5          | 36   | 30.5 | 19 | 22 |                  |
| 1DT9-20-04SP   | M20X1.5   | R1/4"X19   | 12             |    | 19.5          | 36   | 28   | 19 | 24 |                  |
| 1DT9-20-06SP   | M20X1.5   | R3/8"X19   | 12             |    | 19.5          | 36   | 30.5 | 19 | 24 |                  |
| 1DT9-22-06SP   | M22X1.5   | R3/8"X19   | 14             |    | 23            | 41   | 32.5 | 22 | 27 |                  |
| 1DT9-22-08SP   | M22X1.5   | R1/2"X14   | 14             |    | 23            | 41   | 36   | 22 | 27 |                  |
| 1DT9-24-06SP   | M24X1.5   | R3/8"X19   | 16             |    | 24            | 42.5 | 33.5 | 24 | 30 |                  |
| 1DT9-24-08SP   | M24X1.5   | R1/2"X14   | 16             |    | 24            | 42.5 | 37.3 | 24 | 30 |                  |
| 1DT9-30-08SP   | M30X2     | R1/2"X14   | 20             |    | 28.3          | 49.8 | 41   | 30 | 36 |                  |
| 1DT9-30-12SP   | M30X2     | R3/4"X14   | 20             |    | 28.3          | 49.8 | 45.3 | 30 | 36 |                  |
| 1DT9-36-12SP   | M36X2     | R3/4"X14   | 25             |    | 33.3          | 57.3 | 52   | 36 | 46 |                  |
| 1DT9-36-16SP   | M36X2     | R1"X11     | 25             |    | 32.8          | 56.8 | 52.5 | 36 | 46 |                  |
| 1DT9-42-16SP   | M42X2     | R1"X11     | 30             |    | 36.2          | 62.7 | 56.5 | 41 | 50 |                  |
| 1DT9-42-20SP   | M42X2     | R1.1/4"X11 | 30             |    | 36.2          | 62.7 | 57   | 41 | 50 |                  |
| 1DT9-52-20SP   | M52X2     | R1.1/4"X11 | 38             |    | 45.8          | 76.8 | 67   | 55 | 60 |                  |
| 1DT9-52-24SP   | M52X2     | R1.1/2"X11 | 38             |    | 45.8          | 76.8 | 68   | 55 | 60 |                  |

注：如需带卡套及卡套螺母整套订货，则请在代号后加“RN”，如1CT9-30-12SP/RN。

Note: In case if you are interested to order the adapter in complete set with cutting ring and nut ,it is necessary to insert suffix "RN" after our part no., for example 1CT9-30-12SP/RN.